

Renewable Diesel

Frequently Asked Questions



What is renewable diesel?

Renewable diesel is a high-quality diesel fuel made from renewable resources like vegetable oils, animal fats, and waste cooking oils. It is chemically similar to petroleum diesel but has a lower carbon footprint and fewer impurities.



Can renewable diesel be used in all diesel engines?

Yes, renewable diesel is a drop-in fuel, meaning it is fully compatible with all diesel engines without requiring any modifications or special handling.

Is renewable diesel the same as biodiesel?

No, renewable diesel is produced through a refining process called hydrotreating, which results in a fuel that is chemically similar to petroleum diesel. Biodiesel, on the other hand, is made through transesterification and contains fatty acid methyl esters (FAME), making it different in chemical composition.



How does renewable diesel impact greenhouse gas emissions?

Renewable diesel significantly reduces lifecycle greenhouse gas emissions compared to petroleum diesel, with CI scores ranging from 20-50 gCO₂e/MJ, which is substantially lower than petroleum diesel's 95-102 gCO₂e/MJ.



How does renewable diesel affect engine performance?

Renewable diesel has a higher cetane number than petroleum diesel, which can improve combustion efficiency, reduce engine noise, and lead to smoother operation.

Will using renewable diesel void my warranty?

No, using renewable diesel will not void your vehicle or equipment warranty as it meets ASTM D975 standards, the same as petroleum diesel.



What are the long-term benefits of using renewable diesel?

Long-term benefits include reduced engine wear and maintenance costs, lower emissions, and a more sustainable and environmentally friendly fuel economy.

Are there any differences in storage or handling for renewable diesel?

No, renewable diesel can be stored and handled just like petroleum diesel, using the same tanks and dispensing equipment.

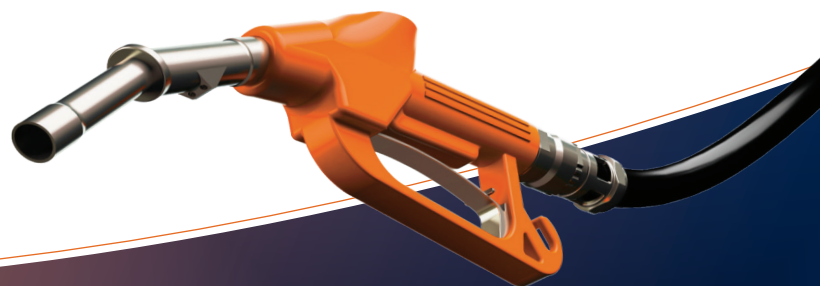

855.335.9448

CHRISTENSENUSA.COM

CHRISTENSEN

FUELS • LUBRICANTS • PROPANE • FLEET CARD